

- ① On-board electrical system battery
- ② High-voltage battery
- ③ Front drive module
- ④ On-Board charger
- ⑤ High-voltage charge socket

Legend

- | | | | |
|---------------------------------------|--------------------------------|--|--------------------------------------|
| Airbag | Gas generator | Seat belt pretensioner | SRS control unit |
| Active pedestrian protection system | Gas strut / Preloaded spring | Alternative high-voltage disconnect device | Low-voltage battery (Li-ion battery) |
| High-voltage battery (Li-ion battery) | High-voltage cable / component | High-voltage disconnect | |

Note

Further information is available in our [Guidelines for Car Rescue Crews](#).



High-voltage disconnect device

The high-voltage disconnect device is located on the right side of the engine compartment.

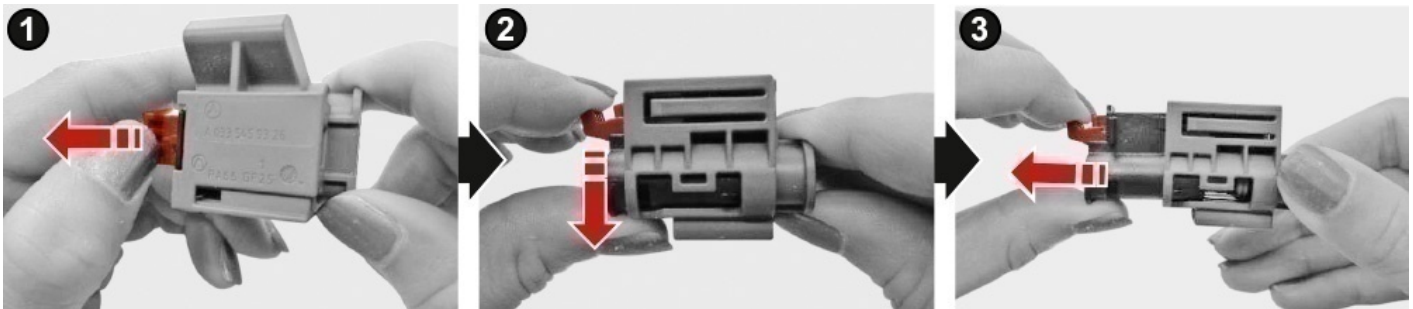
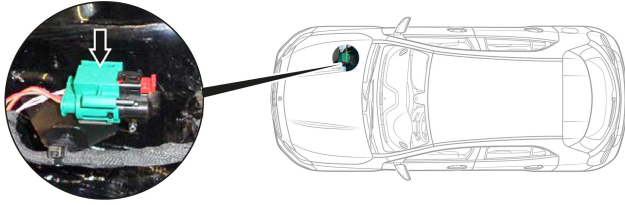

1. Operate release / 2. Push the release downwards / 3. Pull out switch

Alternative high-voltage disconnect device

The alternative high-voltage disconnect device is located behind the cover in the cockpit. It is marked with an information label.





Remove cover (1) of fuse box / Cut line at marked location (2)

Vehicle identification

